

RESEARCH TEAM PROFILES

FACULTY

Faculty of Business and Economics

RESEARCH AREA

Taxation, Harmonization, Fiscal Coordination, Environment Taxation

RESEARCH TEAM

Assoc. Prof. Danuše Nerudová, PhD., team leader, contact: d.nerudova@seznam.cz, tel.: +420 776 757 766

Veronika Solilová, PhD., Mendel University in Brno, Czech Republic

Assoc. Prof. Jitka Janová, PhD., Mendel University in Brno, Czech Republic

Assoc. Prof. Petr Rozmahel, PhD., Mendel University in Brno, Czech Republic

Marian Dobranschi, PhD., Mendel University in Brno, Czech Republic

Mag. Dr. Peter Huber, WIFO Vienna, Austria

Univ.-Prof. Dr. Michael Lang, WU Vienna, Austria

Assoc. Prof. Pasquale Pistone, IBFD Amsterdam, Netherlands

Assoc. Prof. Daniel Smit, Tilburg University, Netherlands

Prof. Daniel Deák, Corvinus University of Budapest, Hungary

EXPERT/TECHNICAL PROFILE OF THE TEAM (SPECIFIC PART OF RESEARCH)

European Union Integration: harmonization and coordination, CCCTB, financial sector taxation, environment taxation, fiscal coordination and sustainability of the taxation system.

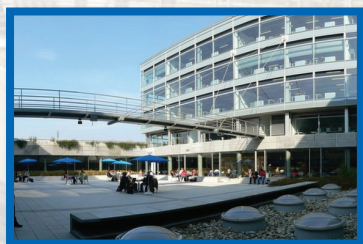

EUROPEAN UNION
EUROPEAN REGIONAL DEVELOPMENT FUND
INVESTING IN YOUR FUTURE



EXPERIENCE

Participation in national projects (programme and provider)

- Selected Aspects of Performance of the Czech Economy and its Effects on the Process of Integration into the EU (GACR-Czech Science Foundation, GA402/03/1105), 2003–2005
- Development of Human Resources in Research and Development at the Faculty of Business and Economics, Mendel University in Brno (European Social Fund, Czech Ministry of Education, Youth and Sport), 2011–2014
- The Czech Science Foundation, grant No. 402/07/0547. The impact of financial reporting harmonization for small and medium-sized enterprises in relation to the income tax base construction, 2007–2009
- Study of the impact of Euro on the Czech Economy (Czech Ministry of Finance), Chapter on analysis of tax consequences, 2007–2008
- The Czech Science Foundation, grant: Evaluation of the Czech Republic convergence to Eurozone, 2008–2010
- The Czech Science Foundation, grant No. P403/11/0849. US GAAP and IAS/IFRS Convergence with respect to the adjustment of methodical procedures of the financial analysis, 2011–2013
- The Czech Science Foundation, grant No. 13-21683S. The quantification of the impact of the introduction of Common Consolidated Corporate Tax Base on the budget revenues of the Czech Republic, 2013–2015
- The Czech Science Foundation, grant No. 15-24867S. Small and medium size enterprises in global competition: Development of specific transfer pricing methodology reflecting their specificities, 2015–2017
- The Czech Science Foundation, grant No. 13-25897S. Nonholonomic constraints in optimal managing of dynamic economic systems in agriculture and natural resources, 2013–2015

Conference organization etc. (national and international)

- 2007: Economic Performance of European Union: Trends and Policies; November 22.–23., 2007, Mendel University in Brno
- 2008: Economic and Monetary Union: 10 Years of Success?; November 27.–28., Mendel University in Brno
- 2009: Financial Crisis: Institutions and Policies; November 26–27, 2009, Mendel University in Brno
- 2010: Financial and Economic Crisis: Causes, Consequences and the Future, November 25.–26., 2010, Mendel University in Brno
- 2011: Enterprise and Competitive Environment. March 2011, Mendel University in Brno
- 2011: Fiscal Stabilisation and Monetary Union: Heritage of the Past and Future Challenges, November 24.–25., 2011, Mendel University in Brno
- 2012: Enterprise and Competitive Environment. March 2012, Mendel University in Brno
- 2012: Legal and economic analysis of FTT in the EU. May 2012, Mendel University in Brno
- 2012: Political Economy of Eurozone Crisis: Is Fiscal Union Feasible? International Scientific Conference. 22.–23. 11. 2012, Mendel University in Brno.
- 2013: Legal and economic analysis of FTT in the EU. February 2013, Madrid, Spain
- 2013: Enterprise and competitive Environment. March 2013, Mendel University in Brno
- 2013: Eurozone Future: From Crisis to Stabilization, Reform and Growth? November 28–29
- 2014: Enterprise and competitive Environment. March 2014, Mendel University in Brno
- 2014: What is Eurozone's Future: Policy Commitments vs. Freeriding, November 27.–28., Mendel University in Brno

Involvement in cross-border / regional and bilateral cooperation

- WU Vienna, Austria
- WIFO Vienna, Austria
- Tilburg University, Netherlands
- Corvinus University of Budapest, Hungary
- IBFD Amsterdam, Netherlands

Involvement in European (especially in Framework Programmes projects, EUREKA, EUROSTARS, COST etc.) and international cooperation

- HORIZON – EURO1 - Societal Challenges – FairTax Consortium – 2015–2018 under the leadership of UMEA University
- Economic and legal analysis of FTT introduction in the European Union – joint project of IBFD, Mendel University, Corvinus University Budapest, Complutense University, Said Business School of Taxation and University of Salerno.
- Wealth, Welfare and Work for Europe – 7th Framework Program Project (led by WIFO Vienna); duration 2012–2015
- Centrepe Pilot Activity: Regional Development Report (in cooperation with WIFO Vienna) – European Regional Fund, Central Europe Programme

Other foreign activities and contacts (active participation in conferences, publications, membership in international bodies etc.)

- Czech Economic Society
- European Association of Tax Law professors
- International Fiscal Association
- European Accounting Association



EUROPEAN UNION
EUROPEAN REGIONAL DEVELOPMENT FUND
INVESTING IN YOUR FUTURE

